

ATF-395



Face Recognition Time & Attendance Terminal

ATF-395 face recognition time & attendance terminal support up to 3,000 face templates, 10,000 fingerprint/card/password (For 3,000 Users Only) with TimeWatch latest hardware platform and algorithm. It offers brand new UI and user-friendly operation interface to provide smooth user experience. With advanced face algorithm and multi-biometric verification technology, the terminal's security level of verification is significantly enhanced.

Features

- 3,000 face and 10,000 fingerprint 10,000 card /password templates
- High verification speed
- Advanced and user-friendly UI
- Built-in battery backup
- Providing approximately 2 to 4 hours of continuous operation (depend on usage)
- New framework firmware, easy to extend functions and customize client's requirements
- One face template is registered for one user only & 3 finger
- Built in access control
- Time Zone
- Door (Open/Close)
- User -Validity

SPECIFICATIONS

- User Capacity : 10,000
- Face Capacity : 3,000
- Finger Capacity : 10,000
- Log Capacity : 2,00,000
- Password Capacity: 10,000
- Card Capacity : 10,000 (EM / MiFare-Optional)
- Communication Interface : TCP/IP,(Host & Slave)
- FRR : 0.001%
- FAR : 0.00001%
- LCD : 2.8" TFT Color Screen
- Verification Time : <0.5 Sec
- Fingerprint Image Display : Yes
- Operating Voltage: DC 12V/2A
- Battery Backup: Yes
- Access Control : Yes
- Sensor : 600DPI
- Built In Cloud
- Optional GPRS/GPS

Applications



Education



Retail



Government



Health



Logistics



Bank



Office

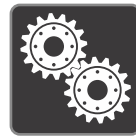

Factory

Configuration

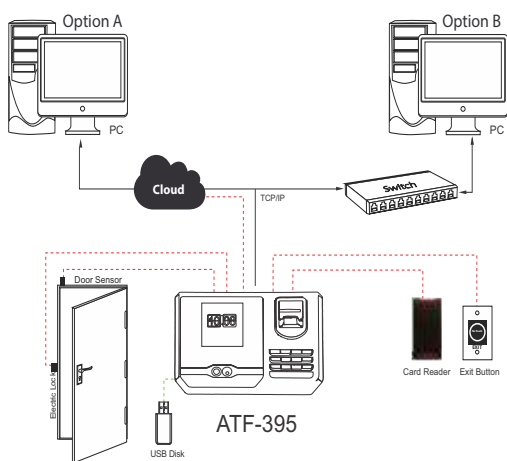

What's in the Box

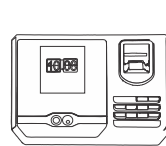

ATF-395

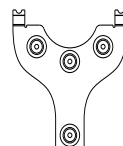

Back Plate

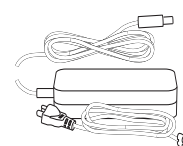

Power Adapter

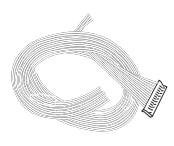

Lines for Access Control Interface



Screws and Holders

www.timewatchindia.com

DISCLAIMER : Brief specification are mentioned here. Specification may change without prior notice. Customer are advised to check with us before purchase
Actual product may differ slightly to that depicted for ongoing product development